



REGISTERED OFFICE

406 Onyx, Akshar Cross Road,
O. P. Road, Vadodara 390020.
Gujarat. INDIA.

FOR FURTHER SUPPORT

CALL US ON

+91 9408630765
+91 7930256667
+91 2652280178

WRITE TO US AT

support@jaaz.in

www.jaaz.in

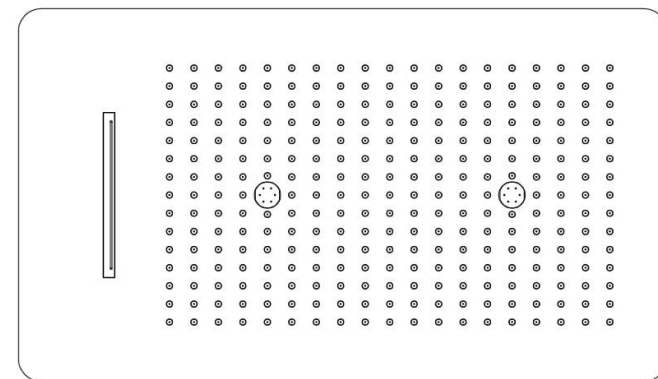

Rain shower
MFS-WF2M

Parts List

Model : MFS-WF2M
 Size : 574.00mm x 330.00mm
 Function: Rain / Mist / Waterfall

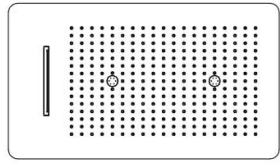

Shower head

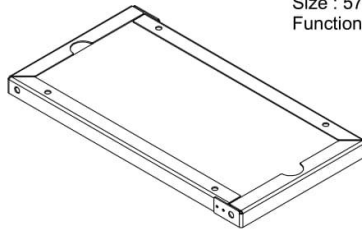

Bracket



X 12

Nut

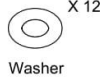

X 12

Washer



Allen Key



Strong Anchor



Stud bolt

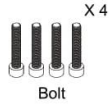

X 4

Bolt



Filter

Dimensions

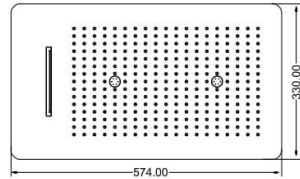
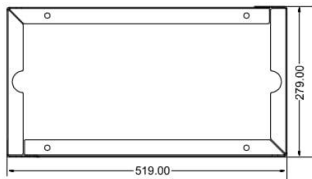

➔ For assembly you will need:

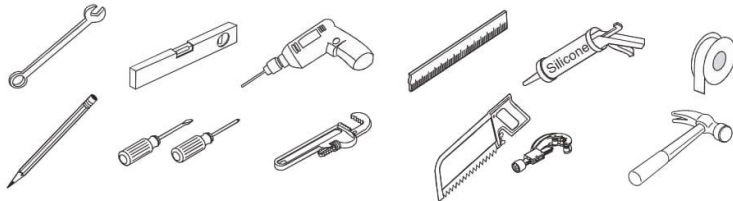

Installation Guide

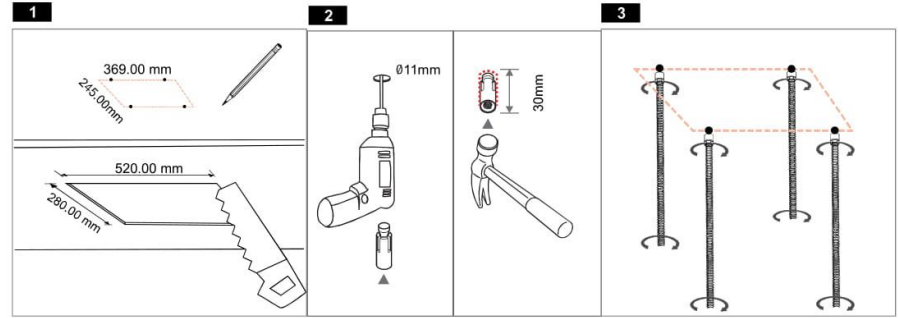

1 Cut the false ceiling to install the bracket and mark 4 position on the upper ceiling for strong anchor.
2 Make the 4 holes (11dia, 30mm dip) on the 4 marks. Put the 4 strong anchors into the holes and hit them with a hammer.
3 Screw 4 stud bolts to the anchor bolts and fasten each bolt.

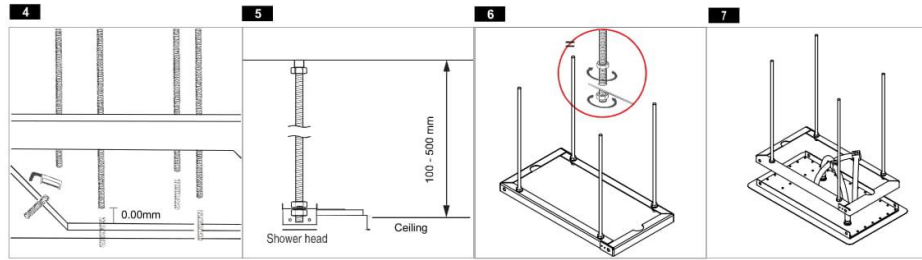

4 Check the length between the false ceiling and built-in bracket. Cut the stud bolt according to the measured value. Put one nut to each stud bolt.
5 Put the bracket to the false ceiling.
6 Tighten the stud bolts with 4 nuts and adjust the height.
7 Put the shower head to the bracket. Connect water supply hose to the shower head.

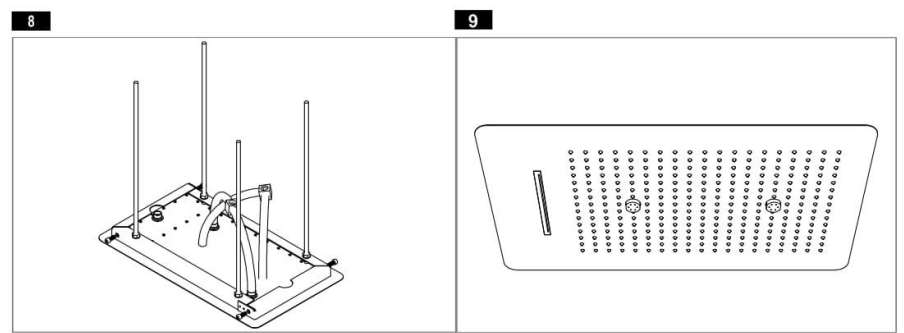

Fix 4xM8 Bolt